

TS-DS

CSI Division: 06 61 13

# Diamond Series



Copyright © 2000 Mincey Marble Manufacturing, Inc.™



- 10" x 20" Vertical Stacked Block Pattern
- Permanently Sealed Surface
- Matte Finish
- Repels Mold and Mildew
- Easy to Maintain
- 1/4" Thick Cast Marble Product
- Manufactured in the USA
- Extremely Sanitary

# SPECIFICATIONS



## Specifications:

- All panels are made oversized and must be measured and cut to fit on site.
- Uses include, but are not limited to, Tub & Shower Surrounds.
- Accessory and color options are available at [www.minceymarble.com](http://www.minceymarble.com).
- All panel sizes reversible

## Panel Sizes:

WIDTH	HEIGHT	THICKNESS
30"	UP TO 96"	1/4"
34"	UP TO 96"	1/4"
36"	UP TO 96"	1/4"
48"	UP TO 96"	1/4"
60"	UP TO 96"	1/4"

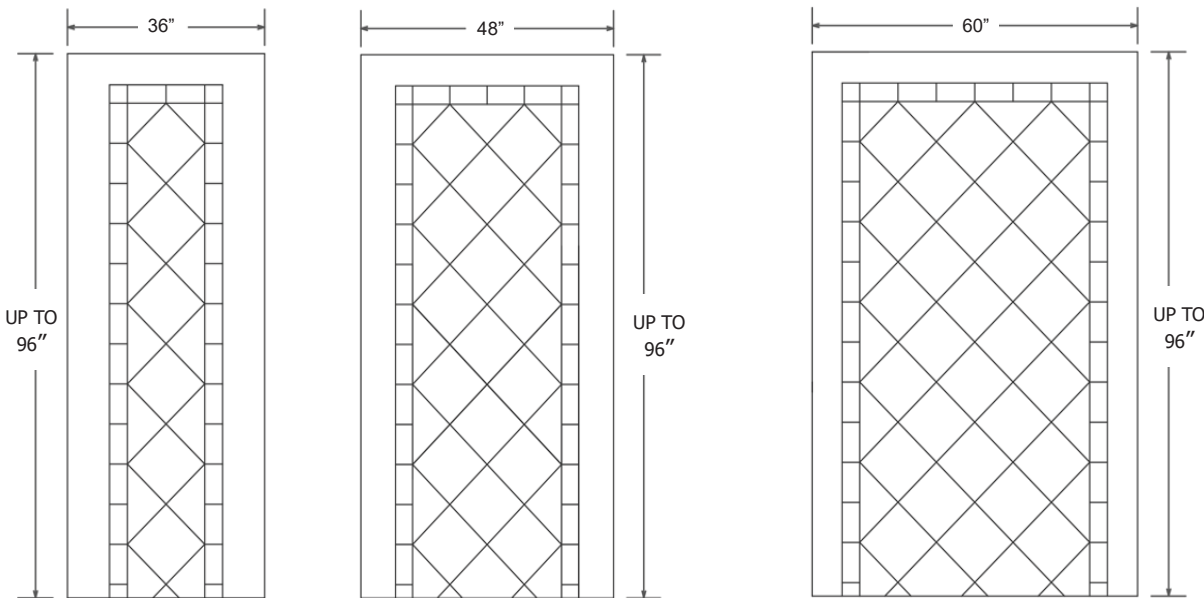
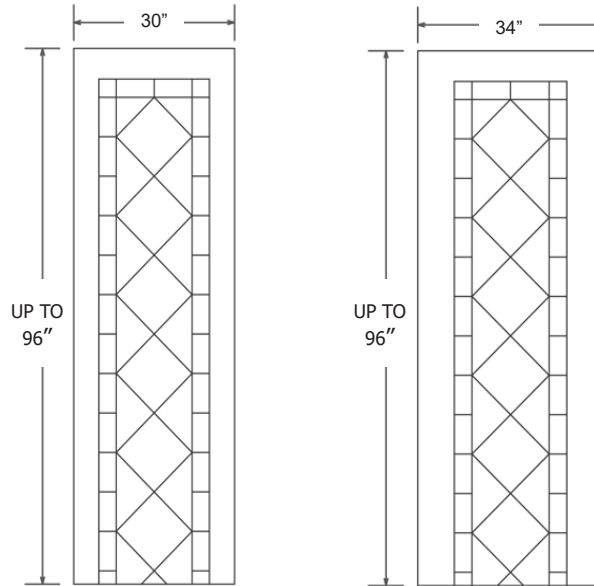

## NOTES

1. Recommend panels extend to the ceiling for tubs and showers. Drawing shows maximum panel dimensions. Cutting must be done on site to fit project requirements.
2. Panels received will be oversized. Trimming to fit site dimensions is necessary. Always trim end panels on the inside, where they meet the back wall.
3. Recommend all caulking to match surround color.
4. Extremely sanitary, impervious to mold, mildew, & bacteria. Panels have appearance of grout without sanitary & moisture issues associated with grout.
5. 10-year limited warranty against manufacturing defects.
6. MINCOR™ - Class A fire rated per ASTM e84 : Fire rated material available upon request.
7. 100% designed and manufactured in the U.S.A. using locally sourced raw materials
8. Compliant with ANSI/BIFMA X7.1 Standard
9. Copyright © 2000 Mincey Marble Manufacturing, Inc.™