



**Mincey Marble Mfg., Inc.**

4321 Browns Bridge Road  
Gainesville, GA 30504

Ph: 800.533.1806

Fx: 770.531.0935

[www.minceymarble.com](http://www.minceymarble.com)

**Installation Instructions for Mincey Marble Manufacturing's**

**Old World Classic 12" x 12" – Separate Listello  
Panel Surrounds – Textured Slate Finish**

**Product number: TS-OWC/12" x 12" - SL**



TS-OWC/12 x 12 - SL

**Please read the following before attempting to install tub/shower  
surrounds:**

*These instructions have been written for the Old World Classic 12x12-SL Separate Listello Panel Surrounds. If you have a different pattern than shown below, please call us for instructions for the design you have purchased.*

**NOTE: We do not recommend using this type of surround for lower than ceiling height surrounds, as you must cut the top of the panels, if necessary, to adjust the height of the panels. In doing so, you will have a raw edge where the cut is.**

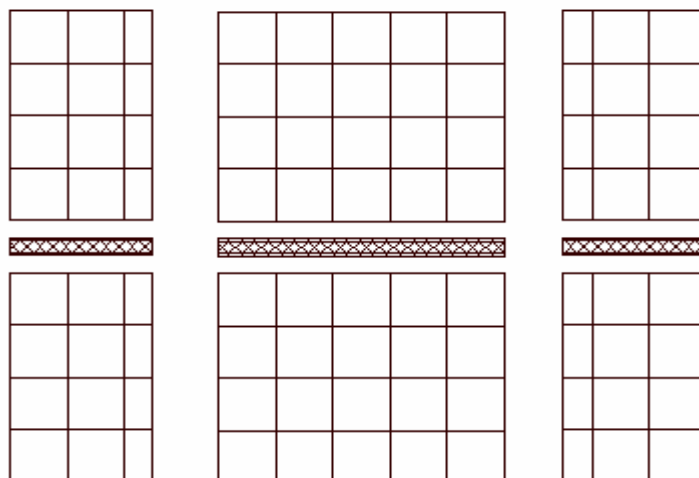

**Special care must be taken in handling these panels, especially in cold weather. The indented grout lines are of necessity a little thinner than other areas of the panels causing this type of panel to be more fragile than our typical cultured marble panels.**

**IMPORTANT:** Panels are to be at room temperature (65 degrees or above) when being cut and during installation. If panels have been stored outside in cold weather, bring them inside 24 hours prior to installation so they can warm. If this is not possible, use extreme caution as cold weather makes the panels brittle and may cause excessive breakage. This type of breakage is not covered by Mincey Marble's warranty.

**IMPORTANT:** The tub or pan should be installed before the sheet rock. This is so that the flanges on the tub/pan will be behind the sheet rock. If the tub/pan is installed after the sheet rock, the flange will be outside the edge of the sheet rock when the panels are installed, the bottoms of the panels will be bowed outward. If the pan is already installed and the flanges are outside the sheet rock, an additional piece of sheet rock should be installed so that the flange is underneath the sheet rock, but should stop about 1" above the flange. The sheet rock around the entire enclosure should not be resting on the flange of the tub/pan. (See drawing A).

**Drawing A:**

## Standard Pans

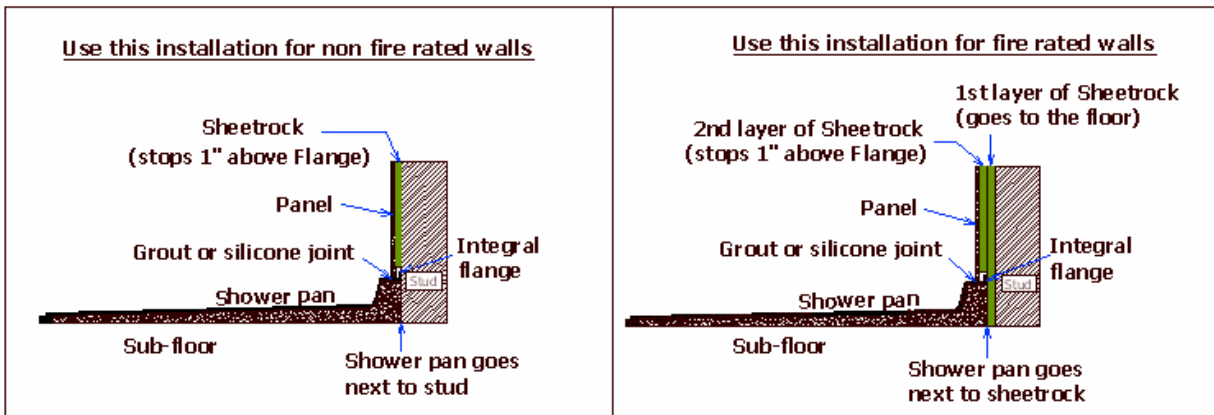

## Standard Tubs

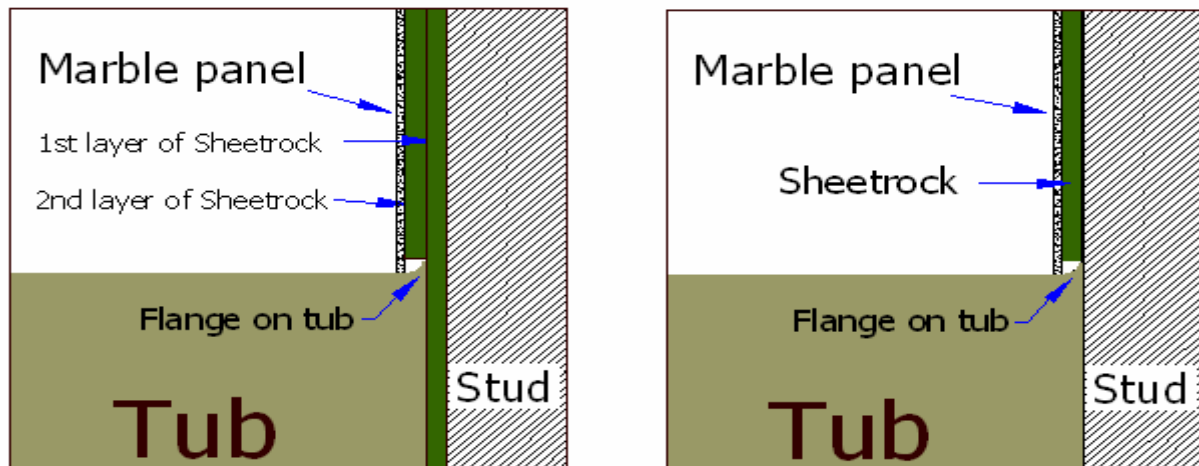

**IMPORTANT:** If grab bars are to be installed, blocking (either 2x4 or 2x6) should be installed behind the sheet rock before attempting to install the grab bars on the panels. The holes for the grab bars should be pre-drilled in the same area of the blocking prior to installing the grab bars. Failure to do this will cause the grab bars to come loose and could cause breakage or cracking of the panels. This type of breakage is not covered by Mincey Marble's warranty.

**IMPORTANT:** These panels are assembled on the job, beginning with the bottom piece of each panel first, then the listello is installed, and finally, the top portion of the panel is installed. The bottom piece will have four full blocks. If any trimming is necessary, to ensure that the top of the panel is level, it should be trimmed from the bottom of the panel.

### **Materials/Tools required:**

1. Circular Saw with a masonry blade
2. Drill for using hole saws
3. Saw horses
4. 2x4s for saw horses to help support the panels
5. Sandpaper (recommend using 80 grit) for sanding cut edges
6. Measuring tape
7. Pencil
8. 4' level
9. Acetone
10. Dry rag
11. Construction adhesive to adhere panels to drywall
12. Hole saw or jig saw to cut holes for plumbing fixtures
13. 100% Silicone for marble to marble seams
14. Latex caulk for marble to drywall seams
15. 1" x 2" or 1" x 4" material for bracing panels

1. **Installer's note:** It is important that before you begin installation of the marble shower surrounds, that you check the level of the tub or shower pan. Check the level of the pan by placing your level on the curb of the pan. Check the level of the tub by placing your level on the deck of the tub. If you have a marble pan and it is out of level, you may be able to shim the low side. If you need to level the pan with shims, you will need to also check to make sure the pan does not rock. If it is rocking, you will need to add shims to stop the rocking. If you have a tile pan, a maximum tolerance for being out of level is  $\frac{1}{4}$ ". The maximum tolerance for seams in cultured marble shower is  $\frac{1}{8}$ ".

2. Go from the lowest point on your tub/pan and measure up with your tape measure on the back wall and make a mark on that wall 47  $\frac{3}{8}$ " from that point (This is the height of 4 full blocks). Use a level to make a level line on the wall, from corner to corner. You will make a level line on the other walls to be covered with marble off of this line. Do this now, also. Make the lines for the sidewalls to extend to the edge of the tub/pan. Using a level, make a vertical (plumb) line flush with the outside edge of the pan curb or the outside edge of the tub, extending to the top of where the panel will end.

3. Now that the reference lines have been drawn, you can proceed with the installation of the bottom section of the back panel. You will need to begin installation of the panels with the back wall. If the tub/pan or floor is not level, you will want to trim the bottom of the panel so that the top of the panel will be level when installed. (For example: If the tub/pan is  $\frac{1}{8}$ " out of level, with the right side being low, you will want to trim  $\frac{1}{8}$ " from the left side of the panel going to nothing

on the right side of the panel.) Measure from the horizontal line to the top of the tub/pan on each side and in the middle. This will be the height measurement for the panels. Trim the bottom of the panel, keeping the top un-cut for best fit of the listello (border) piece. Sand cut edges with 80 grit sandpaper to help prevent chipping and to keep from cutting hands while handling. Dry fit the panel in position and ensure that the seams are good. Once you are satisfied with the seam on the bottom of the panel, clean the back of the panel with acetone (do not use water based cleaners or denatured alcohol), this will make for better bonding to the wall. Clean the wall with a dry rag to remove dust. Now apply adhesive to the wall. Large pads of adhesive works best for adhering to the wall. Now set the panel in place, pressing firmly against the panel to ensure proper adhesion.

4. The listello will be installed next. Simply trim to fit and adhere to the wall In the same manner as above. The listello has “grout lines” built into the top and bottom of the listello. The top of the bottom panel and the bottom of the top panel should not have a grout line, but have a factory edge, without grout on it.

5. The top part of the wall will be installed next. You shouldn't have to cut the panel on the top to keep the panel level, however you will need to trim the panel at the top to go to the ceiling.

6. The same procedure for measuring the bottom portion of the back wall will be followed on the side panels. Make sure to trim the bottom of the panel first. (There should not be much to trim off the bottom, especially if the tub/pan is perfectly level). The width of the panel will be determined by measuring from the back panel to the vertical line on the wall, even with the edge of the tub/pan. Trim this panel on the backside of the panel (a full block should be on the outside edge of the panel). Dry fit the panel, making sure the grout lines are even and the top of the bottom portion of the side walls are even. If they do not line up, trim or shim the bottom of the panel to get them aligned. Clean the back of the panel as with the back wall and clean the wall. Apply adhesive in large pads and install the panel. The rest of the panel will be installed in the same manner as the back walls.

7. On the plumbing wall, you will want to measure from your plumb and horizontal level lines to the center of the valves and water outlet(s), to ensure accurate placement of the holes for the plumbing. **Mark the placement of your plumbing holes after the panel has been trimmed to fit.** Cut the holes for the plumbing with a hole saw or jig saw, making sure not to cut the holes too large for the plumbing trim to cover. Dry fit the panel, making sure the grout lines are even. Follow the same procedures as above for finishing installation of this panel.

8. Once all of the panels have been installed, brace the walls with scrap 1x2's or 1x4's. Make sure to use a short board on the end of each brace to distribute the pressure of the bracing. Do not put too much pressure on the panels, especially at the grout lines or along the border (listello).

9. Once the adhesive has dried, you can remove the braces. You will caulk the seams with 100% silicone that closely matches the color of the panels. All of the seams inside the shower enclosure should be caulked with silicone. The outside edges of the panels touching sheet rock or wallpaper can be caulked with a latex caulk.

**Please call Mincey Marble Manufacturing at 800.533.1806 with any questions.**