



Mincey Marble Mfg., Inc.

4321 Browns Bridge Road
Gainesville, GA 30504

Ph: 800.533.1806

Fx: 770.531.0935

www.minceymarble.com

Installation Instructions for Mincey Marble Manufacturing's

**Diamond Panel Surrounds – for Renovations
- Matte Finish**

Product number: TS- DS/ RENO



TS-DS/ RENO

Please read the following before attempting to install tub/shower surrounds:

These instructions have been written for the TS-DS/Renovation Diamond Panel Surrounds – matte finish. These surrounds should have a two piece back wall with a 4" seam cover and two side panels. If you have a different pattern than shown below, please call us for instructions for the design you have purchased.

Special care must be taken in handling these panels, especially in cold weather. The scored lines are of necessity a little thinner than other areas of the panels causing this type of panel to be more fragile than our typical cultured marble panels.

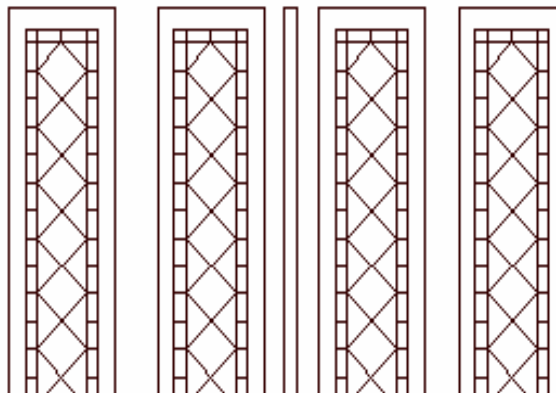

Installer's note: The tub/pan should be installed before the sheet rock. This is so the flanges on the tub/pan will be behind the sheet rock. If the tub/pan is installed after the sheet rock, the flange will be outside the edge of the sheet rock and when the panels are installed, the bottoms of the panels will be bowed outward. If the tub/pan is already installed and the flanges are outside the sheet rock, an additional piece of sheet rock should be installed so that the flange is underneath the sheet rock, but should stop short about 1" above the flange. The sheet rock around the entire enclosure should not be resting on the flange of the tub/pan. (See drawing A).

Drawing A:

Standard Pans

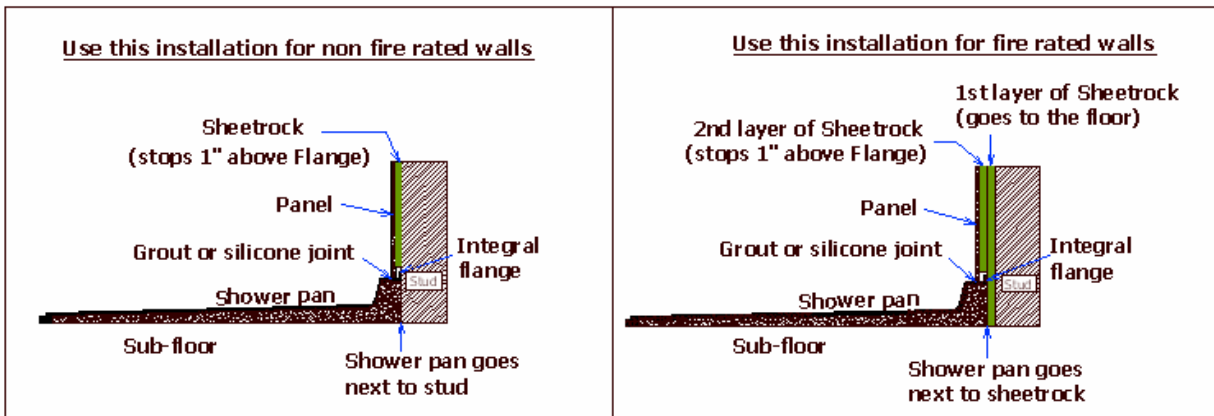

Standard Tubs

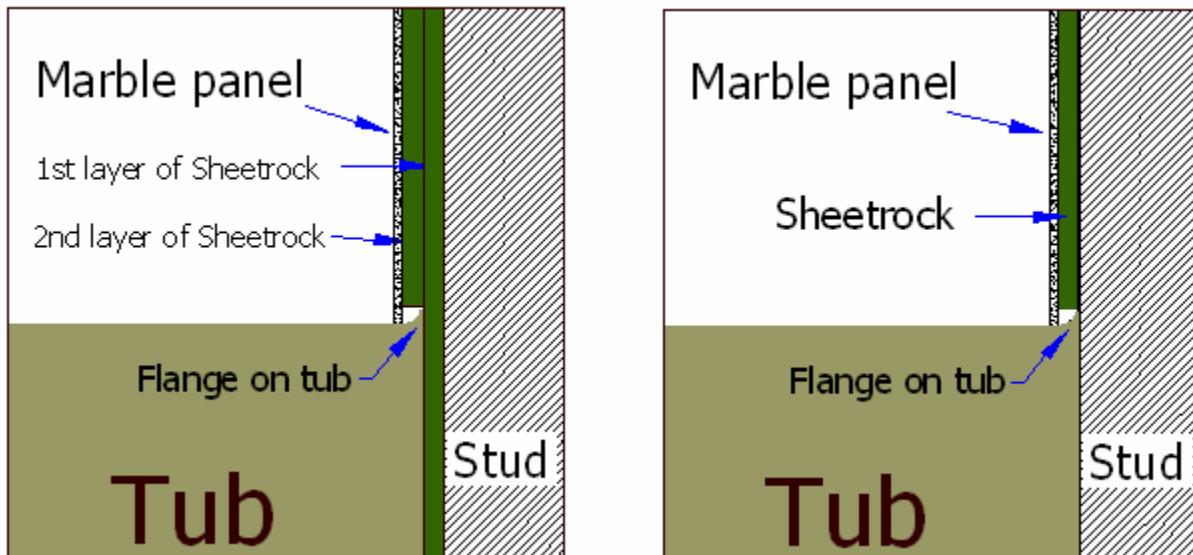

IMPORTANT: Panels are to be at room temperature (65 degrees or above) when being cut and during installation. If panels have been stored outside in cold weather, bring them inside 24 hours prior to installation so they can warm. If this is not possible, use extreme caution as cold weather makes the panels brittle and may cause excessive breakage. This type of breakage is not covered by Mincey Marble's warranty.

IMPORTANT: If grab bars are to be installed, blocking (either 2x4 or 2x6) should be installed behind the sheet rock before attempting to install grab bars on the panels. The holes for the grab bars should be pre-drilled in the area of the blocking prior to installing the grab bars. Failure to do this will cause the grab bars to come loose and could cause breakage or cracking of the panels. This type of breakage is not covered by Mincey Marble's warranty.

Materials/Tools required:

1. Circular Saw with a masonry blade
2. Drill for using hole saws
3. Saw horses
4. 2x4s for saw horses to help support the panels
5. Sandpaper (recommend 80 grit) for sanding cut edges
6. Measuring tape
7. Pencil
8. 4' level
9. Acetone
10. Dry rag
11. Construction adhesive to adhere panels to drywall
12. Hole saw or jig saw to cut holes for plumbing fixtures
13. 100% Silicone for marble to marble seams
14. Latex caulk for marble to drywall seams
15. 1" x 2" or 1" x 4" material for bracing panels

To install the panels:

Installer's note: The Diamond Pattern Surrounds have a border on the top and both sides. If you have gloss diamond pattern surrounds, you will need to call us to request different instructions to be sent to you. The matte diamond pattern surrounds are available in various widths including 30", 34", 36", 48" and 60" and may be ordered up to 96" in height, depending on your needs. The back panel may be ordered in one piece or 3 pieces depending upon job conditions.

To install the panels:

1. Check to see that the tub/pan is level from front to back and left to right. The maximum tolerance for level is +/- 1/4". Also note that a gap of 1/8" is the maximum tolerance on marble seams.
2. Using a pencil, mark a level line at the desired height of the back panel*. If the tub/pan is not level, measure the line from the lowest point of the tub/pan. Using a level, extend the line out on the left and right sides. This is the line you will measure to for the height of your panels. Using a 4' level, mark a vertical plumb line in the center of the back wall. You will use this line to measure the two back panels. Using a 4' level, draw a vertical (plumb) line flush with the outer edge of the tub/pan, extending to the height line. This will be the line to measure to for the width measurement of the end panels.

3. The back wall should be installed first. Measure the width of the space where the back wall will be installed. **Equal amounts should be trimmed from each side of the panel to ensure the diamond pattern remains centered on each of the the walls.** Measure from the vertical line in the middle of the back wall to each side. This will be the dimension of each of your back panels. Mark your back panels to these dimensions and trim to fit. Clean the back of the panels with acetone (do not use water based cleaners or denatured alcohol) and the wall with a dry rag, making sure there is no dust on either surface. Sand cut edges with 80 grit sandpaper to help prevent chipping and to keep from cutting hands while handling. "Dry fit" the panels to make sure your cuts are straight. Remove the panels and apply adhesive to the wall. Large pads of adhesive will ensure proper gluing. The 4" seam cover will be trimmed to fit and be placed over the seam on the back wall.
4. Measure the end panels, using the lines you have already made on the walls. It is usually easier to measure the plumbing wall first. **Equal amounts should be cut from each side of the side panels as well to ensure that the diamond pattern remains centered on the wall. The 2" wide trim will cover the cut on the outside of the panel.** Measure and trim the panel, then measure and cut the holes for the plumbing. This will assure that the holes will not be off-center. Use a hole saw or jig saw to cut these holes. **Make sure the holes for the plumbing are not too large for the plumbing trim to cover.** After this panel has been dry fit and installed, you can install the other panel, following the same measuring technique.
5. After all three walls have been installed; it is best to brace the walls with 1x4 or 1x2 scrap, being careful not to put too much pressure on the panels, as they are fragile. Use a small block of wood on the ends of each side of your brace to help distribute the pressure.
6. Install trim next to the side panels, measuring from the tops of the panels to the floor.
7. Install soap dishes on panels. If using cultured marble soap dishes, see separate instructions for these.
8. After the adhesive has had time to dry, remove the bracing and caulk all of the joints where marble touches marble or the tub with 100% silicone that closely matches the color of the marble. Caulk the marble to sheet rock walls with a latex caulk.

* If the height of the panels will go to the ceiling, you will not need to draw a level line across the top of the wall. Instead, you will need to check that the ceiling is level and if not, trim the top of the panel accordingly.

Please call Mincey Marble Manufacturing at 800.533.1806 with any questions.