



**Mincey Marble Mfg., Inc.**  
4321 Browns Bridge Road  
Gainesville, GA 30504  
Ph: 800.533.1806  
Fx: 770.531.0935  
[www.minceymarble.com](http://www.minceymarble.com)

## Installation Instructions for Mincey Marble Manufacturing's

**Traditional Panel Surrounds  
- Renovation projects**

**Product number: TS-TR/RENO**



**TS-TR/RENO**

**Please read the following before attempting to install your cast stone renovation tub and shower surrounds**

*These instructions have been written for Mincey Marble's TS-TR – Traditional Renovation cast stone tub and shower panel surrounds. These surrounds should have a two piece back wall with a 10" seam cover and two side panels. If you have a different pattern than shown below, please call us for instructions for the design you purchased.*

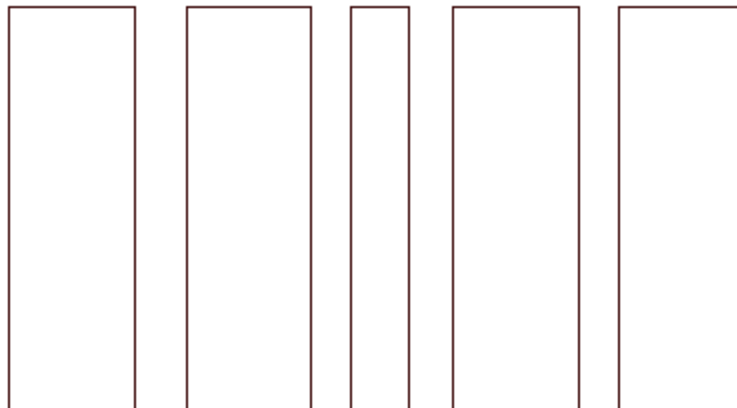

**INSTALLERS NOTE:** The tub/pan should be installed before the substrate. This is so the flanges on the tub/pan will be behind the substrate. If the tub/pan is installed after the substrate, the flange will be outside the edge of the substrate and when the panels are installed, the bottoms of the panels will be bowed outward. If the tub/pan is already installed and the flanges are outside the substrate, an additional piece of substrate should be installed so that the flange is underneath the substrate, but should stop about 1" above the flange. The substrate around the entire enclosure should not be resting on the flange of the tub/pan. (See drawing A).

**Drawing A:**

## Standard Pans

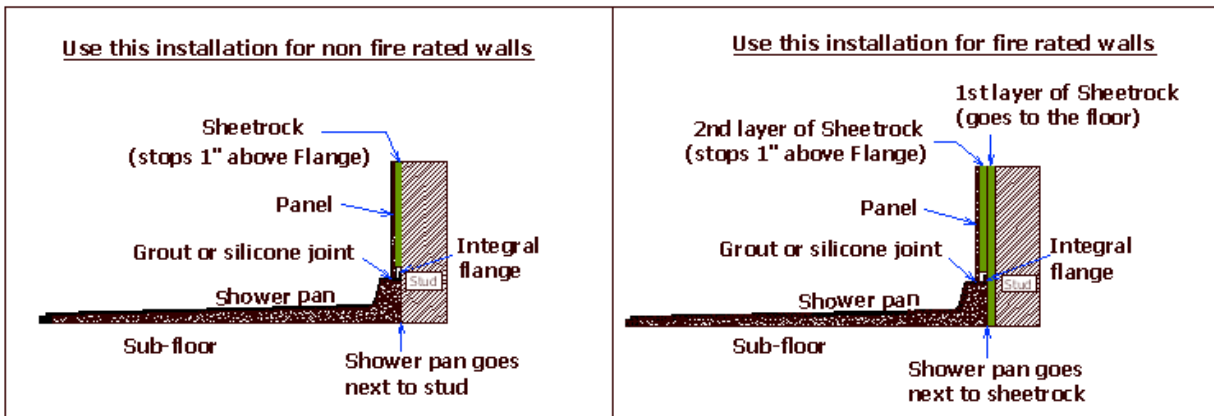

## Standard Tubs

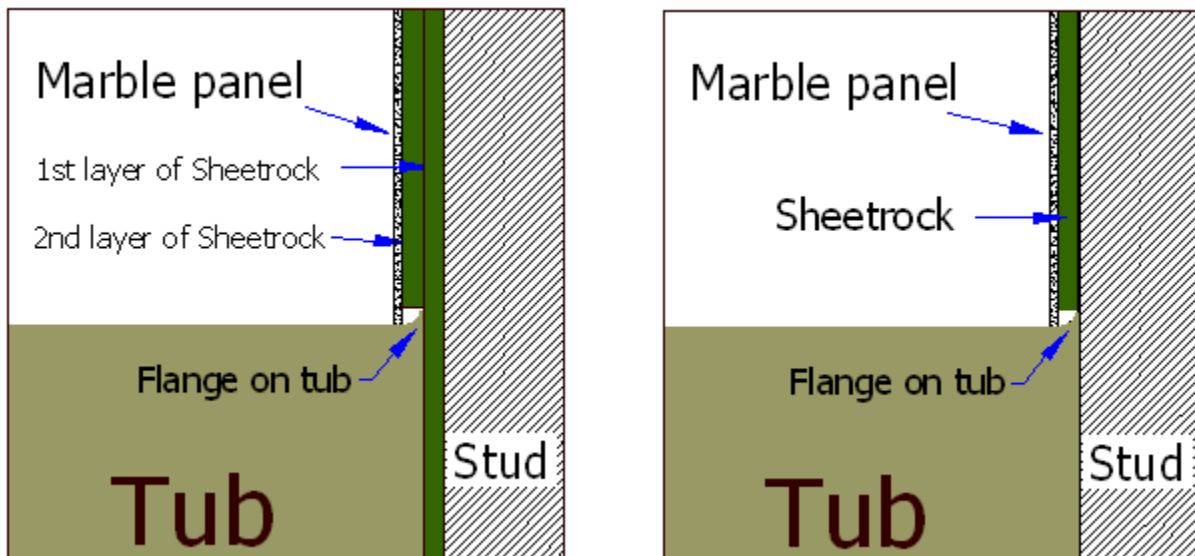

**IMPORTANT:** Panels are to be at room temperature (65 degrees or above) when being cut and during installation. If panels have been stored outside in cold weather, bring them inside 24 hours prior to installation so they can warm. If this is not possible, use extreme caution as cold weather makes the panels brittle and may cause excessive breakage. This type of breakage is not covered by Mincey Marble's warranty.

**IMPORTANT:** If grab bars are to be installed, blocking (either 2x4 or 2x6) should be installed behind the substrate before attempting to install grab bars on the panels. The holes for the grab bars should be pre-drilled in the area of the blocking prior to installing the grab bars. Failure to do this will cause the grab bars to come loose and could cause breakage or cracking of the panels. This type of breakage is not covered by Mincey Marble's warranty.

### **Materials/Tools required:**

1. Circular Saw with a masonry blade
2. Drill for using hole saws
3. Saw horses
4. 2x4s for saw horses to help support the panels
5. Sandpaper (recommend 80 grit) for sanding cut edges
6. Measuring tape
7. Pencil
8. 4' level
9. Acetone
10. Dry rag
11. Construction adhesive to adhere panels to drywall
12. Hole saw or jig saw to cut holes for plumbing fixtures
13. 100% Silicone for marble to marble seams
14. Latex caulk for marble to drywall seams
15. 1" x 2" or 1" x 4" material for bracing panels

### **Installing the Traditional Renovation panels:**

1. Check to see that the tub/pan is level from front to back and left to right. The maximum tolerance for level is +/- 1/4". Also note that a gap of 1/8" is the maximum tolerance on marble seams.
2. Using a pencil, mark a level line at the desired height of the back panel\*. If the tub/pan is not level, measure the line from the lowest point of the tub/pan. Using a level, extend the line out on the left and right sides. This is the line you will measure to for the height of your panels. Using a 4' level, draw a vertical (plumb) line flush with the outer edge of the tub/pan, extending to the height line. This will be the line to measure to for the width measurement of the end panels. Measure the width of the opening, divide that in half and mark a vertical line on the back wall in the middle of this opening, using your level, to keep the line plumb. You will use this line to measure the width of each of the back panels.
3. The back wall should be installed first. This panel will be installed in three pieces (2-30" panels and a seam cover-usually 10"). Measure each of the two back panels from the lines you have made there. Mark your back panels to these dimensions and trim to fit **Note: the seam should be in the middle of the panels.** Clean the back of the panels with acetone (do not use water based cleaners or denatured alcohol) and the wall with a dry rag, making sure there is no dust on either surface. Sand cut edges with 80 grit sandpaper to help prevent chipping and to keep from cutting hands while handling. "Dry fit" the panels to make sure your cut is straight. Remove the panels and apply adhesive to the wall. Large pads of adhesive will ensure proper gluing. The seam trim will be installed over the seam, in the middle of the back panel.

4. Measure the end panels, using the lines you have already made on the walls. It is usually easier to measure the plumbing wall first. Measure and trim the panel, then measure and cut the holes for the plumbing. This will assure that the holes will not be off-center. Use a hole saw or jig saw to cut these holes. **Make sure the holes for the plumbing are not too large for the plumbing trim to cover.** After this panel has been dry fit and installed, you can install the other panel, following the same measuring technique.
5. After all three walls have been installed; it is best to brace the walls with 1" x 4" or 1" x 2" scrap, being careful not to put too much pressure on the panels, as they are fragile. Use a small block of wood on the ends of each side of your brace to help distribute the pressure.
6. Install trim next to the side panels, measuring from the tops of the panels to the floor (if applicable). Trim is designed to run from the top of the panel to the floor.
7. Install soap dishes on panels. If using cultured marble soap dishes or ceramic soap dishes, see separate instructions for these.
8. After the adhesive has had time to dry, remove the bracing and caulk all of the joints where marble touches marble or the tub with 100% silicone that closely matches the color of the marble. Caulk the marble to substrate walls with a latex caulk.

**\*NOTE:** IF PANELS ARE TO EXTEND TO THE CEILING, THIS LEVEL LINE WILL NOT BE NECESSARY. INSTEAD YOU WILL NEED TO DETERMINE HOW MUCH THE TUB/PAN AND CEILING ARE BOTH OUT OF LEVEL AND TRIM THE TOP AND BOTTOM OF THE PANELS ACCORDINGLY.

**If you have any questions, please call Mincey Marble Customer Service at 800.533.1806.**