



**Mincey Marble Mfg., Inc.**

4321 Browns Bridge Road  
Gainesville, GA 30504

Ph: 800.533.1806

Fx: 770.531.0935

[www.minceymarble.com](http://www.minceymarble.com)

**Installation Instructions for Mincey Marble Manufacturing's**

**3" x 6" Subway with River Rock Listello  
Surrounds – Gloss Finish only**

**Product number – TS-VN/3" x 6" w/RR**



**TS-VN – Subway w/RR**

**Please read the following before attempting to install your Subway  
with River Rock listello cast marble tub and shower surrounds.**

*These instructions have been written for Mincey Marble's Vintage Series 3" x 6" Subway  
Simulated Brick with River Rock listello cast marble tub and shower panel surrounds. If  
you have a different pattern than shown below, please call us for instructions for the  
design you have purchased.*

**Special care must be taken in handling these panels, especially in cold weather. The  
indented grout lines are of necessity a little thinner than other areas of the panels  
causing this type of panel to be more fragile than our typical cast marble panels.**

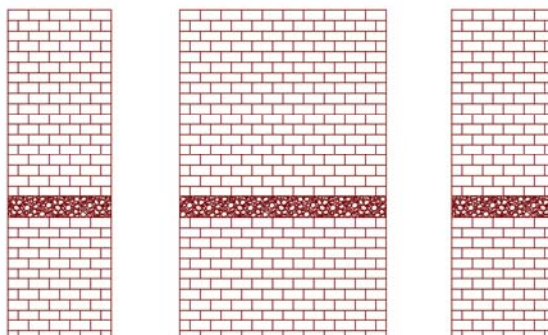

**INSTALLERS NOTE:** The tub or pan should be installed before the substrate. This is so the flanges on the tub/pan will be behind the substrate. If the tub/pan is installed after the substrate, the flange will be outside the edge of the substrate and when the panels are installed, the bottoms of the panels will be bowed outward. If the tub/pan is already installed and the flanges are outside the substrate, an additional piece of substrate should be installed so that the flange is underneath the substrate, but should stop about 1" above the flange. The substrate around the entire enclosure should not be resting on the flange of the tub/pan. (See drawing A).

Drawing A:

## Standard Pans

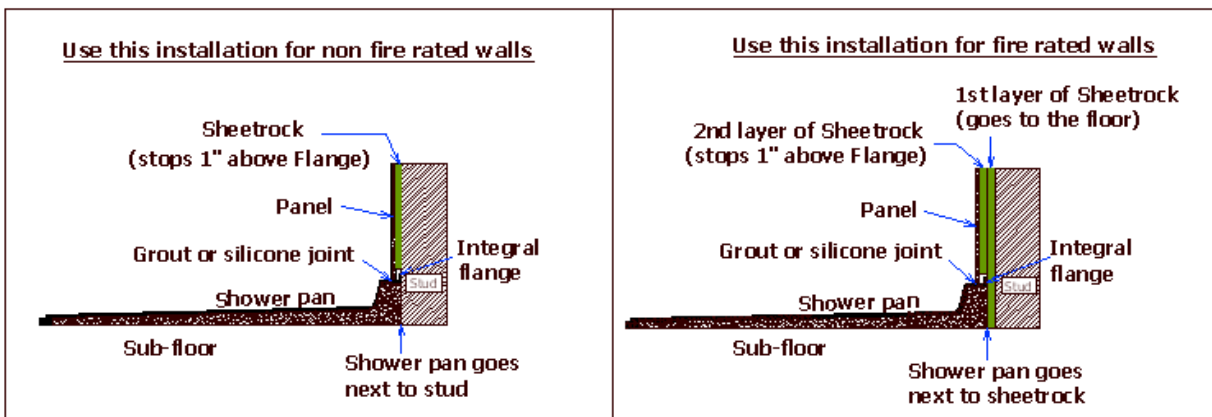

## Standard Tubs

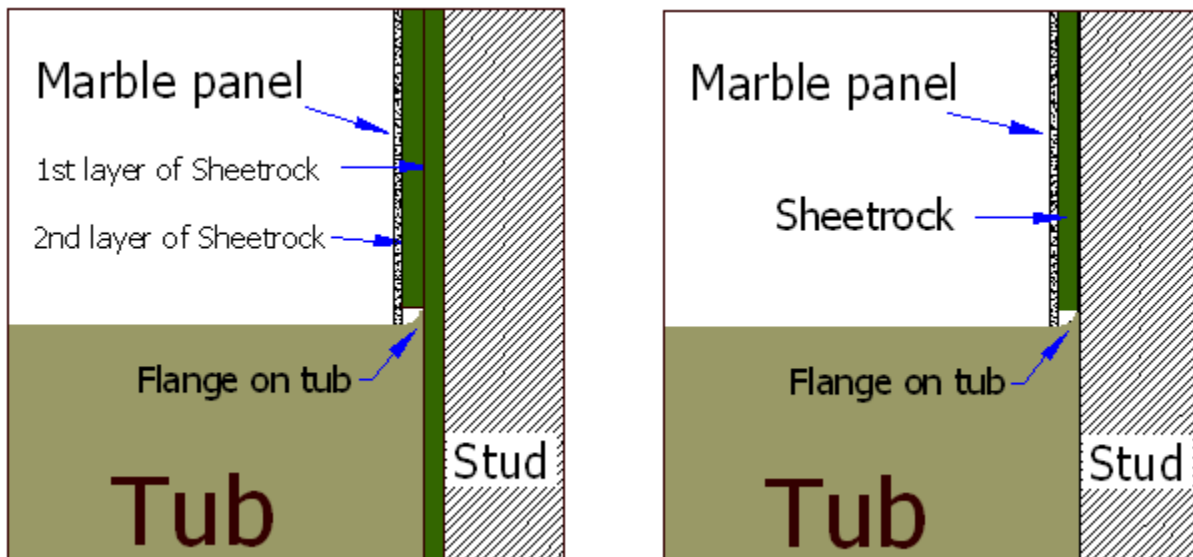

**IMPORTANT:** Panels are to be at room temperature (65 degrees or above) when being cut and during installation. If panels have been stored outside in cold weather, bring them inside 24 hours prior to installation so they can warm. If this is not possible, use extreme caution as cold weather makes the panels brittle and may cause excessive breakage. This type of breakage is not covered by Mincey Marble's warranty.

**IMPORTANT:** If grab bars are to be installed, blocking (either 2x4 or 2x6) should be installed behind the substrate before attempting to install grab bars on the panels. The holes for the grab bars should be pre-drilled in the area of the blocking prior to installing the grab bars. Failure to do this will cause the grab bars to come loose and could cause breakage or cracking of the panels. This type of breakage is not covered by Mincey Marble's warranty.

**IMPORTANT:** To get the best possible look with these surrounds, it is important to align the grout lines. **The best way to accomplish this is after the back panel has been installed and the overall measurements of the side panels have been taken, you want to measure up from the tub or shower base to one of the grout lines in the middle of the panel.** Before you cut the height of the side panels, measure from the same spot on the side panels and if needed you can cut a little off the top and bottom of the side panels to help align the grout lines. If you have any questions about this procedure, please call customer service at 800.533.1806.

### **Materials/Tools required:**

1. Circular Saw with a masonry blade
2. Drill for using hole saws
3. Saw horses
4. 2x4s for saw horses to help support the panels
5. Sandpaper (recommend 80 grit) for sanding cut edges
6. Measuring tape
7. Pencil
8. 4' level
9. Acetone
10. Dry rag
11. Construction adhesive to adhere panels to drywall
12. Hole saw or jig saw to cut holes for plumbing fixtures
13. 100% Silicone for marble to marble seams
14. Latex caulk for marble to drywall seams
15. 1" x 2" or 1" x 4" material for bracing panels

**Installers note: You will need to start the top of all of the panels at the exact same place so that the "grout joints" will meet in the corners.**

### **Installing the Subway with River Rock listello panels:**

1. Check to see that the tub/pan is level from front to back and left to right. The maximum tolerance for level is +/- 1/4". Also note that a gap of 1/8" is the maximum tolerance on marble seams.
2. Using a pencil, mark a level line at the desired height of the back panel\*. If the tub/pan is not level, measure the line from the lowest point of the tub/pan. Using a level, extend the line out on the left and right sides. This is the line you will measure to for the height of your panels. Using a 4'level, draw a vertical (plumb) line flush with the outer edge of the tub/pan, extending to the height line. This will be the line to measure to for the width measurement of the end panels.

3. The back wall should be installed first. Check each side for plumb. If both walls are plumb, measure the width of the space where the back wall will be installed. Mark your back panel to these dimensions and trim to fit. **Cut equal amounts off each side of the back panel to keep the tile pattern centered on the wall.** Clean the back of the panel with acetone (do not use water based cleaners or denatured alcohol) and the wall with a dry rag, making sure there is no dust on either surface. Sand cut edges with 80 grit sandpaper to help prevent chipping and to keep from cutting hands while handling. "Dry fit" the panel to make sure your cut is straight and the seam at the bottom is within tolerance. When satisfied with the seam, remove the panel and apply adhesive to the wall. Large pads of adhesive will ensure proper gluing. Then install the panel in its place.
4. Measure the end panels, using the lines you have already made on the walls. It is usually easier to measure the plumbing wall first. You will need to cut the panel to desired dimensions before cutting the plumbing holes. Measure and trim the panel (*cut the panel on the side butting up to the back wall-do not cut the outside edge of the panel*). Now, measure and cut the holes for the plumbing. Use a hole saw or jig saw to cut these holes. **Make sure the holes cut for the plumbing are not too large to be covered by the plumbing trim. Make sure when you dry fit the panel that the grout lines are even. If they are not, trim or shim the panel as necessary to get these lines even.** After this panel has been dry fit and installed, you can install the other panel, following the same measuring and installation technique.
5. After all three walls have been installed; it is best to brace the walls with 1x4 or 1x2 scrap, being careful not to put too much pressure on the panels, as they are fragile. Use a small block of wood on the ends of each side of your brace to help distribute the pressure.
6. Install trim next to the side panels, measuring from the tops of the panels to the floor (if applicable).
7. Install soap dishes on panels. If using cast marble soap dishes or ceramic soap dishes, see separate instructions for these.
8. After the adhesive has had time to dry, remove the bracing and caulk all of the joints where marble touches marble or the tub with 100% silicone that closely matches the color of the marble. Caulk the marble to sheet rock walls with a latex caulk.

**\*NOTE: IF PANELS ARE TO BE CUT TO GO TO THE CEILING, THIS LEVEL LINE WILL NOT BE NECESSARY. INSTEAD YOU WILL NEED TO DETERMINE HOW MUCH THE CEILING IS OUT OF LEVEL AND TRIM THE TOP OF THE PANELS ACCORDINGLY.**

**If you have any questions, please call Mincey Marble Customer Service at 800.533.1806.**